



Skydio 2 Enterprise



Breakthrough intelligence. Impossible video.

Skydio 2 (S2) is the industry-leading autonomous drone. S2 combines the AI-powered flight autonomy engine with a compact, lightweight airframe, making it the most intelligent, safest and simplest drone to operate in the market. Thanks to real-time 360° obstacle avoidance and motion prediction capabilities, S2 redefines the operational paradigm of drones, eliminating the risk of crashes and turning anyone into an expert pilot. Equipped with NVIDIA Tegra TX2 with 256 GPU cores, S2 brings industry-leading compute power to the edge of your infrastructure, automating data collection for situational awareness, inspection or security. Designed, assembled, and supported in the USA, S2 provides higher degree of supply chain security.

Optional add-ons

- **Skydio Beacon™**. A first-of-its-kind drone controller for subject tracking and intuitive “magic wand” control.
- **Skydio Autonomy™ Enterprise Foundation**: 360 Superzoom, precision mode, vertical view and more.
- **Skydio 3D Scan™**. First-of-its-kind digital scan software for inspections of complex structures, such as bridges, energy infrastructure, or crash and crime scenes.
- **Skydio House Scan™**. Residential roof-top scanning software to enable fully autonomous capture of precision imagery by home insurance agents. Delivered through EagleView.



SITUATIONAL AWARENESS



ASSET INSPECTION



SECURITY AND PATROL

MAX RANGE

3.5
km

CAMERA

4K60 / 12.3
HDR / MP

FLIGHT TIME

23
min

"With the Skydio's advanced sense and avoid technology we are able to perform operations in close proximity to our critical infrastructure with additional assurance that we will be able to meet our business needs safely and more efficiently than traditional methods."

- Fred Judson, Director, Ohio Department of Transportation UAS Center

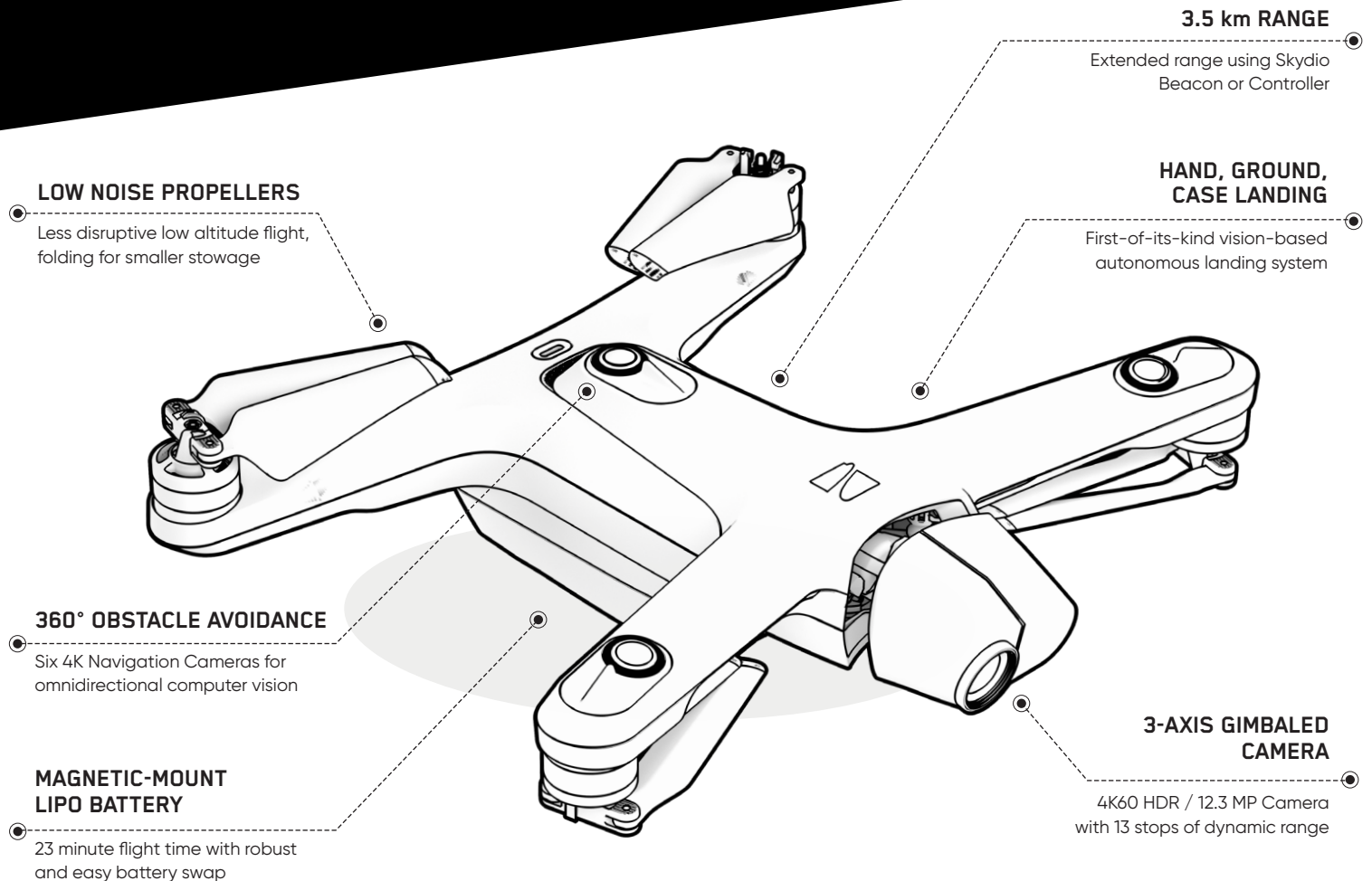

PRIMARY CAMERA

SENSOR TYPE	Sony 1/2.3" 12.3MP CMOS
LENS	f/2.8, 20mm (at 35mm equivalent)
VIDEO RESOLUTION FORMATS	4K at 24, 30, 48, 60 fps
BITRATE	100 Mbps
COLOR PROFILE	HD, UHD, UHD HDR 8-bit
DYNAMIC RANGE	13 stops
STILL RESOLUTION	4056 x 3040 (12.3MP)
STILL FORMATS	JPEG, DNG (RAW)

AUTONOMY SPECS

MAIN PROCESSOR	NVIDIA Tegra X2
6 X NAVIGATION CAMERAS	Sensor - Sony 1/3.06" Lens - f/2.5
FIELD OF VIEW	360°
OBSTACLE AVOIDANCE COVERAGE	Omnidirectional - above & below
ONBOARD AI	9 custom deep networks
3D WORLD MODEL UPDATE RATE	> 1 million points per second
SUBJECTS TRACKED	People, motor vehicles
TRACKING LOAD	up to 10 simultaneous objects



Contact enterprise@skydio.com today to learn more about integrating Skydio 2.

Designed and assembled in the USA